

Hyatt Regency Santa Clara

DIRECTIONS

From San Francisco International Airport

Take Highway 101 South to Great America Parkway and turn left. The hotel is located on the right at the corner of Tasman and Great America Parkway.

From Norman Y. Mineta San Jose International Airport

Turn left onto Airport Boulevard, and then turn left again onto Guadalupe Parkway. Follow the signs to Highway 101 North. Guadalupe Parkway will put you onto Highway 101 North. Take Great America Parkway and turn right.

From North

Take I-880 South and exit to Highway 237 West toward Mountain View. Turn left onto Great America Parkway, and then turn left into the hotel entrance. The hotel is located at the corner of Tasman and Great America Parkway.

From South

Take I-880 North to Highway 101 North and exit at Great America Parkway. Turn right onto Great America Parkway. The hotel is located on the corner of Tasman and Great America Parkway.



SECOND LEVEL

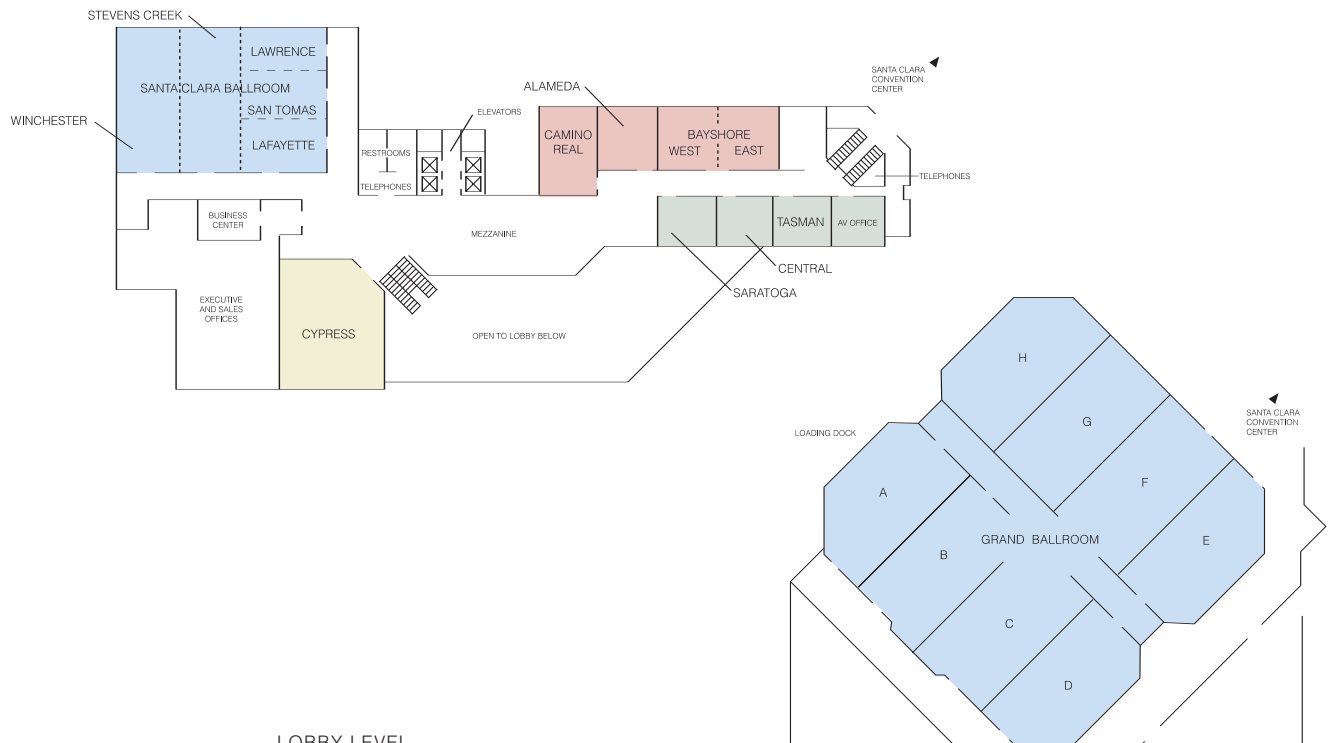

LOBBY LEVEL

